



 blossom⁸

Quick Start Guide

What's in the Box?



- 1 Blossom 8
- 2 Blossom 8 Cover
- 3 Four Wall Screws
- 4 Wire Labels
- 5 Power Supply

What you will need:

- iOS or Android Device
- Internet Connection

1. Label the Wires on your old controller

Keep track of your current zones and label your wires before disconnecting.

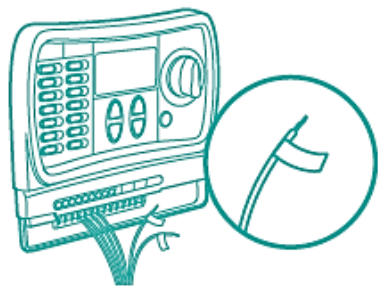

Use the provided labels: orange for zones, black for common, gray for pump start relay.

2. Remove your old controller

Dismount your old sprinkler controller from the wall.

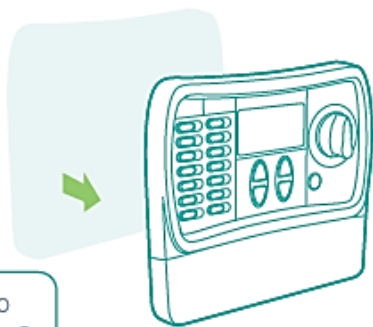

Quick Tip: Take a photo of your wires to reference when connecting to Blossom 8.

3. Install the Blossom 8 Controller

Mount the Blossom 8 Controller with the four provided screws.

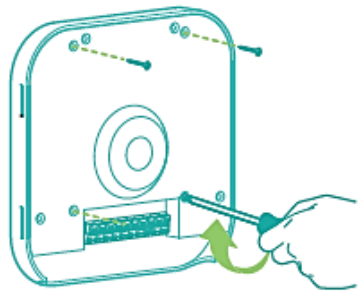

4. Connect the wires

Connect the labeled wires to their corresponding ports. Connect the common wire to the a black connector port.

If installed, connect the wire from the pump start relay to the gray port.

Alternatively, the gray port can be configured as "Zone 8" from the Settings Menu in the Blossom App.

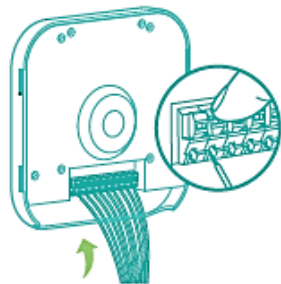

Note: Put away your existing weather sensors. You won't need them. Blossom 8 uses real-time weather data.

5. Plug in

the Blossom 8 Controller

Connect the Power Supply into the Blossom 8 Controller and plug into an available electrical outlet.

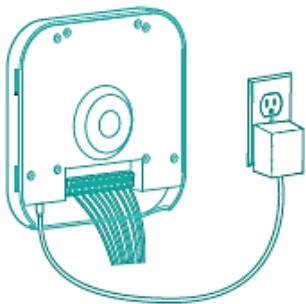

6. Attach the Blossom 8 Cover

on to the Blossom 8 Controller

Secure the Blossom 8 Cover to view the LED status.

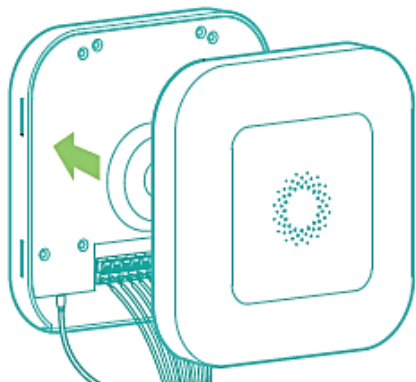

7. Get

the Blossom App

The Blossom App is downloadable from the Apple Store or Google Play and supports all Blossom products.

The Blossom App will guide you through creating your account, syncing your device and connecting your Blossom 8 to the Internet.



8. Pair via Wi-Fi

your Blossom 8 Controller

The Blossom App will help you configure Blossom 8 to connect to your Wi-Fi network.

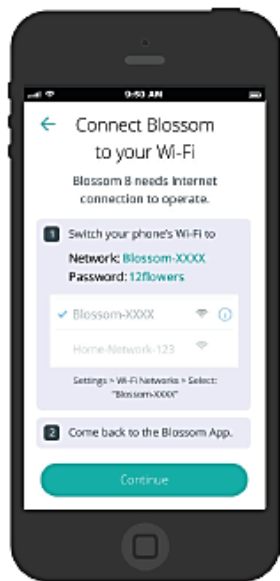

9. Connect

Temporarily switch your phone's Wi-Fi network to the network called: **Blossom-XXXX**, password: **12flowers**

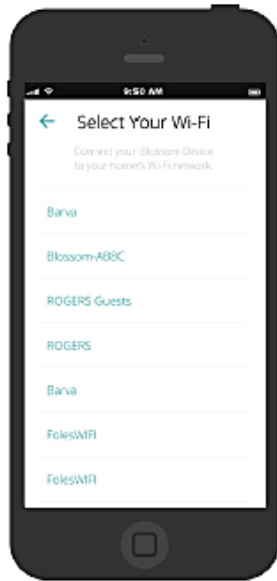

10. Select

After connecting to the Blossom network on your phone, return back to the Blossom App and select your Wi-Fi network and enter the Wi-Fi password.



11. Pair

Enter the Pairing Code (located on the front of the Blossom 8 Controller). Don't forget to reconnect your phone back to your Wi-Fi network.



myblossom.com

Online Support:
myblossom.com/support

Live Support:
+1 855-976-5315



Contains FCC ID:
TLZ-CU288

This device complies with Part 15 of the FCC Rules. Operation is subject to the following two conditions: (1) this device may not cause harmful interference, and (2) this device must accept any interference received, including interference that may cause undesired operation.